

CAULKING, BY INSTALLER
 0.060" CLEAR ANODIZED
 ALUM. CENTER PLATE
 CONT. ALUM. EXPOSED EXTRUSION
 CLEAR ANODIZED FINISH
 FASTENER @ 18" O.C. MAX, BY INSTALLER
 CONT. BASE EXTRUSION, MILL FINISH

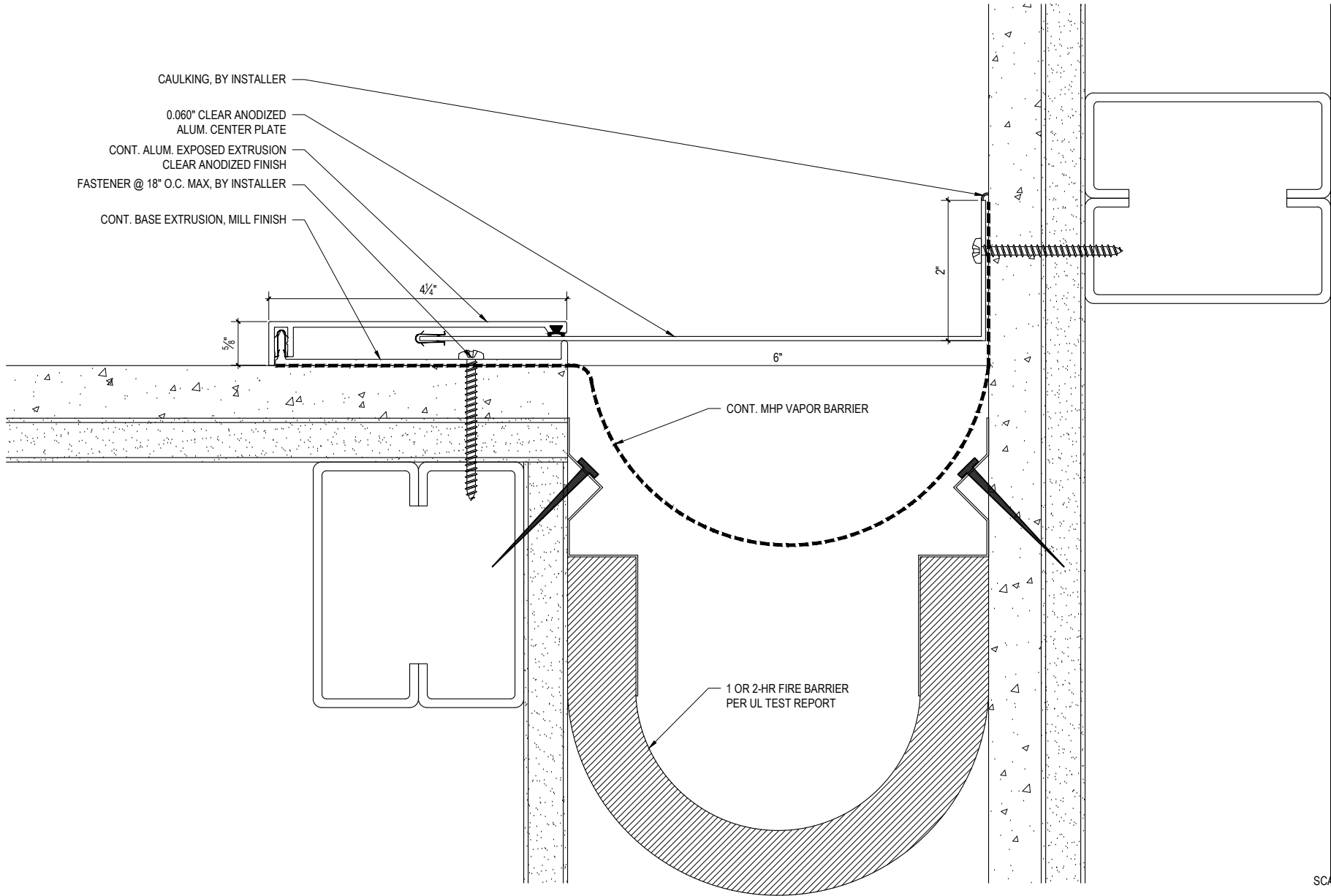

SCALE: x"=1'-0"



M.H. POWELL & CO., INC.
 ARCHITECTURAL SEISMIC EXPANSION JOINT SYSTEMS

2313 YATES AVENUE | PHONE : (323) 887-0037
 COMMERCE, CA 90040 | FAX : (323) 887-0877
 WEB : www.mhpowell.net

**MODEL
 KFM-6-2**

WALL/CEILING CORNER EJC

PROJECT : _____ PROJECT # : _____
 LOCATION : _____ DATE : _____
 ARCHITECT : _____
 CUSTOMER : _____

PAGE #